

SPS 130mm Square Push-in Cleanout

100mm Outlet

Specification codes:

Q130SCR4 (Polished 304 stainless steel)

Q130SCRN6 (Non-slip 316 stainless steel)

For security screws, use suffix /SEC

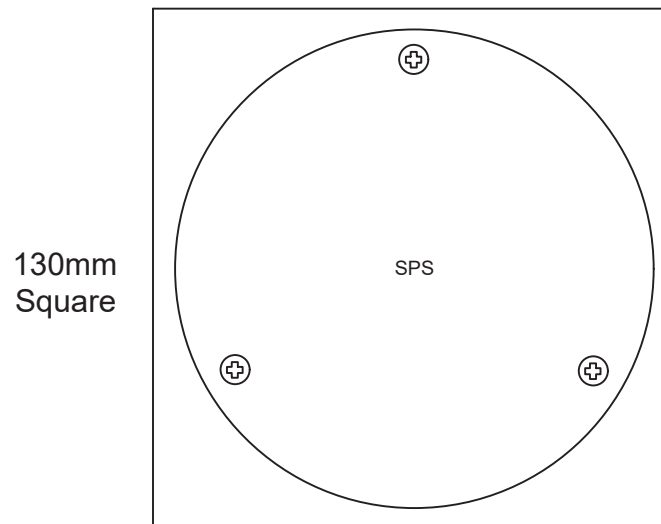

- Light-duty cleanout in cast 304 and 316 stainless steel.
- Gas-tight lid.
- Security screws also available.

⊕ — Optional tamper-proof screws (use suffix "/SEC")

Typical Application

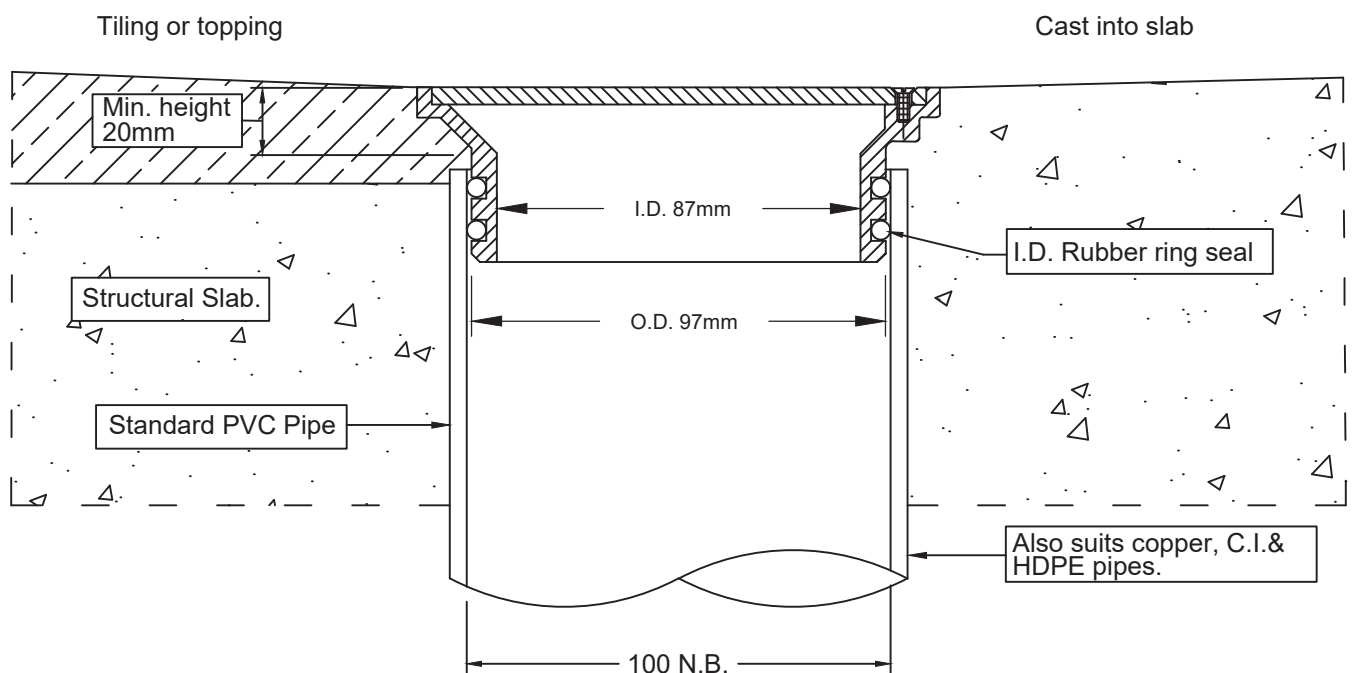

Metabronze Industries Ltd.

Office: 09 441 3824 Email: sales@metabronze.co.nz Website: metabronze.co.nz